

# Three Kings

**Join the village  
within a city**

**Site Liaison Group meeting**

**26 February 2018**

# Contents

1. Special Housing Area update
2. Plan change
3. Land exchange





# Special Housing Area Update



# Plan Change





# Changes proposed

## 1. Finished ground levels

- Playing fields
- Southern terrace

## 2. Remnant volcanic features

- Quarry park, SE bluff, Barrister bluff, Fyvie escarpment

## 3. Maximum building height

- Along Mt Eden Rd and enhanced controls to roofs

## 4. Cascading apartment setbacks

- To improve views from the riu, Mt Eden Rd and Grahame Breed Dve

## 5. Sightlines

- New sightline from SE bluff

## 6. Other controls

- Improved connectivity
- Enhanced storm water management
- Car access to cascading apartments





# Land Exchange



## First land exchange

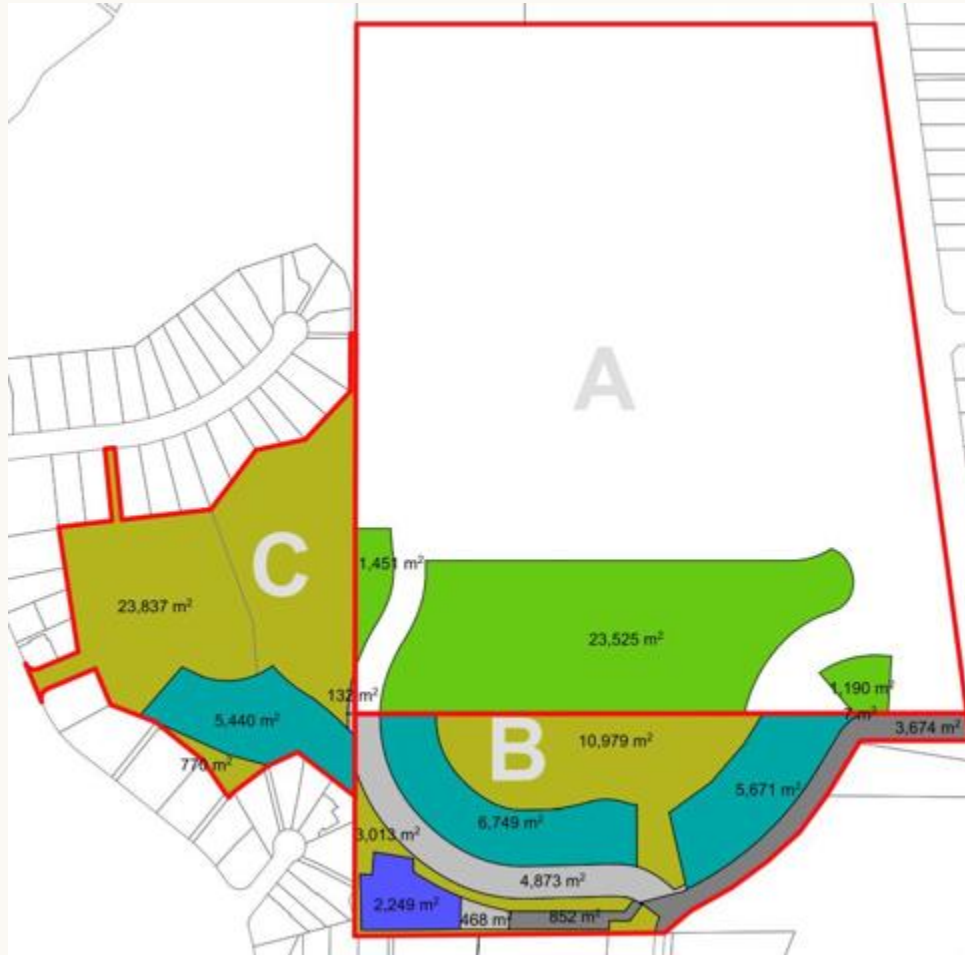

## Second land exchange

